

# Operating Instructions

## Planetary Mill

### „pulverisette 5“



Fritsch GmbH  
Manufacturers of Laboratory Instruments  
Industriestrasse 8  
D - 55743 Idar-Oberstein

Phone: +49 (0)6784/ 70-0  
Telefax: + 49 (0)6784/ 70-11  
E-Mail: Info@FRITSCH.de  
Internet: <http://www.FRITSCH.de>

Fritsch GmbH, Laborgerätebau has been certificated by the TÜV-Zertifizierungsgemeinschaft e.V. on November 21, 2003.



An audit certificated the accordance of the Fritsch GmbH to the DIN EN ISO 9001:2000.

The enclosed declaration of conformity calls the directives which the „pulverisette 5“ corresponds to. This permitts us to mark the instrument with the CE-Sign.



Instrument number 05.5000.00  
applies as of serial number 0492

Instrument number 05.6000.00  
applies as of serial number 0380

| Table of contents |  | page      |
|-------------------|--|-----------|
| <b>1</b>          | <b>General Information / Introduction .....</b>                                    | <b>1</b>  |
| 1.1               | Notes about Operating Instructions.....  | 1         |
| 1.2               | Explanations of the signs at the instrument and in the operating instructions      | 2         |
| 1.3               | Short Description of the Machine .....   | 3         |
| 1.3.1             | Applications .....   | 3         |
| 1.3.2             | Method of Operation .....  | 3         |
| 1.3.3             | Drive Motor and Speed Control.....   | 3         |
| 1.4               | Technical Data.....  | 4         |
| <b>2</b>          | <b>Operating Safety.....</b>   | <b>2</b>  |
| 2.1               | General Safety Instructions.....   | 2         |
| 2.2               | Operators.....   | 3         |
| 2.3               | Protective Devices .....   | 3         |
| 2.4               | Danger Points .....  | 4         |
| 2.5               | Electrical Safety .....  | 4         |
| 2.5.1             | General .....  | 4         |
| 2.5.2             | Protection against Restarting.....   | 4         |
| 2.5.3             | Overload Protection (see 8 Troubleshooting Checklist) .....                        | 4         |
| 2.5.4             | Unbalance Detection (see 8 Troubleshooting Checklist).....                         | 4         |
| 2.5.5             | Operation on a residual current circuit breaker .....                              | 4         |
| <b>3</b>          | <b>Installation.....</b>   | <b>5</b>  |
| 3.1               | Unpacking.....   | 5         |
| 3.2               | Transport .....  | 5         |
| 3.3               | Erection.....  | 5         |
| 3.4               | Ambience conditions .....  | 6         |
| 3.5               | Electrical Connection .....  | 6         |
| 3.6               | Adaptation to Mains Supply Voltage, Changing Timer and Unbalance<br>Detection..... | 6         |
| 3.7               | Switching On for the First Time / Test for Correct Functioning .....               | 7         |
| <b>4</b>          | <b>Working with the mill .....</b>   | <b>8</b>  |
| 4.1               | Choice of Grinding Bowls and Grinding Balls.....                                   | 8         |
| 4.1.1             | Size of the Grinding Balls.....  | 8         |
| 4.1.2             | Number of Balls per Grinding Bowl .....  | 9         |
| 4.1.3             | Calculated Ball Weight.....  | 9         |
| 4.2               | Filling the Grinding Bowl .....  | 10        |
| 4.3               | Influencing Quantities During Grinding .....                                       | 10        |
| 4.3.1             | Dry Grinding.....  | 10        |
| 4.3.2             | Wet Grinding (Grinding in Suspension).....   | 11        |
| 4.4               | Clamping the grinding bowls .....  | 11        |
| 4.4.1             | Clamping with the "Safe Lock" Holder.....  | 11        |
| 4.4.2             | Clamping the 80 ml grinding bowl .....   | 11        |
| 4.4.3             | Clamping with Additional Clamping System.....                                      | 12        |
| 4.5               | Mass Balance .....   | 13        |
| 4.6               | Grinding Time .....  | 13        |
| 4.7               | Control Panel .....  | 14        |
| 4.7.1             | Setting the Speed .....  | 14        |
| 4.7.2             | Setting the Running Time .....   | 14        |
| 4.7.3             | Reversing Operation .....  | 14        |
| 4.7.4             | Repetition of the Grinding / Break Cycles .....                                    | 14        |
| 4.8               | Performing a Grinding Operation .....  | 15        |
| 4.9               | Cooling the Grinding Bowls.....  | 15        |
| 4.10              | Standby.....   | 15        |
| 4.11              | Grinding under protective gas with gas lid .....                                   | 16        |
| 4.12              | GTM System .....   | 18        |
| <b>5</b>          | <b>Cleaning.....</b>   | <b>19</b> |
| 5.1               | Grinding accessories .....   | 19        |
| 5.2               | Mill .....   | 19        |
| <b>6</b>          | <b>Maintenance.....</b>  | <b>20</b> |
| <b>7</b>          | <b>Warranty.....</b>   | <b>21</b> |
| <b>8</b>          | <b>Troubleshooting Checklist.....</b>  | <b>21</b> |
| <b>9</b>          | <b>Examples of Comminution Tasks.....</b>  | <b>22</b> |
| <b>10</b>         | <b>List of Keywords.....</b>   | <b>24</b> |

# 1 General Information / Introduction









## 1.1 Notes about Operating Instructions

- The copyright to these technical documents is the property of Fritsch GmbH, Manufacturers of Laboratory Instruments.
- These operating instructions are not to be reprinted or copied without the express approval of Fritsch GmbH.
- Please study these instructions carefully before operation.
- All operators must be familiar with the contents of the operating instructions.
- Please observe all notes concerning your safety.
- The mill was designed with the user's safety in mind, however inherent risks cannot be excluded. Follow the advices in these instructions to avoid risks to users.
- The symbols in the right hand margin highlight the risks described in the text. Symbols are also to be found on the instrument warning users of possible risks. Warning symbols are surrounded by a triangle.
- These operating instructions do not constitute a complete technical description. They describe only the details required for safe operation and maintenance for usage under normal conditions.



*Attention!  
observe operating  
instructions*

## 1.2 Explanations of the signs at the instrument and in the operating instructions

|  |  |
|--|--|
| <p>Attention!<br/>warning against danger spot<br/>observe operating instructions</p> |    |
| <p>Attention! mains voltage</p>  |    |
| <p>Attention! risk of explosion</p>  |    |
| <p>Attention! hot surface</p>  |    |
| <p>Attention! inflammable substances</p>   |   |
| <p>wear protective gloves!</p>   |  |
| <p>wear ear protectors!</p>  |  |
| <p>wear safety goggles!</p>  |  |
| <p>Do not step below lifted load!</p>  |  |

## 1.3 Short Description of the Machine

### 1.3.1 Applications

The "pulverisette 5" laboratory planetary mill is universally applicable for quick dry or wet grinding of inorganic and organic samples for analysis, quality control, materials testing and mechanical alloying.

In synthesis, the "pulverisette 5" can be used for mixing and homogenisation of dry samples, of emulsions and of pastes.

### 1.3.2 Method of Operation

The material is crushed and torn apart in two or four grinding bowls by grinding balls. The grinding balls and the material in the grinding bowl are acted upon by the centrifugal forces due to the rotation of the grinding bowl about its own axis and due to the rotating supporting disc.

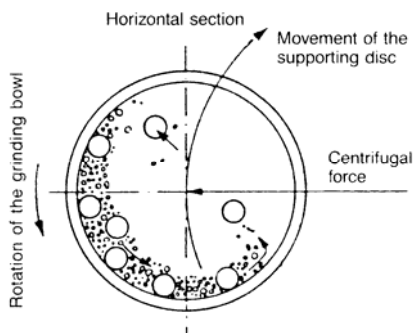
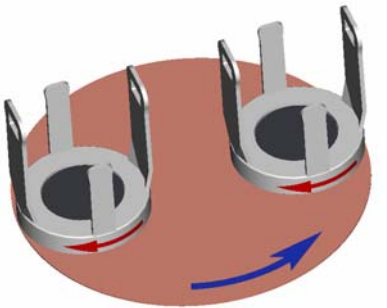

The grinding bowl and the supporting disc rotate in opposite directions, so that the centrifugal forces alternately act in the same and opposite directions.

This results in, as a frictional effect, the grinding balls running along the inner wall of the bowl, and as an impact effect, the balls impacting against the opposite wall of the grinding bowl.

The impact effect is enhanced by the grinding balls impacting against one another.

Loss-free grinding, even in the case of grinding of suspensions, is guaranteed by a hermetic seal between the grinding bowl and the cover.

### 1.3.3 Drive Motor

#### and Speed Control

The machine is driven by a three-phase a.c. motor, which receives three-phase a.c. 230 V of variable frequency from a frequency converter.

## 1.4 Technical Data

### Dimensions and Weight

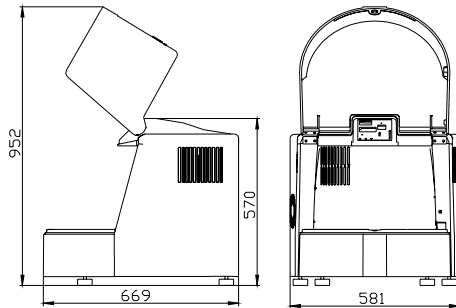

Weight: 120 kg

### Operating Noise

The noise level is about 85dB (A). The value fluctuates greatly depending on the speed and the material being ground and on the type of grinding bowl and grinding balls.

### Voltage

The machine can be operated in two voltage ranges:

- Single-phase alternating voltage 100-120V  $\pm$  10% and
- Single-phase alternating voltage 200-240V  $\pm$  10%.

(see also section 3.6)

Transient overvoltages according to overvoltage category II allowed.

### Current Input

The maximum current input is approx.:

- 100-120V..... 14 A
- 200-240V..... 6 A

### Power consumption

The maximum power consumption is approx. :

- 100-120V..... 1500W
- 200-240V..... 1300W

### Electrical Fuses

Automatic circuit breaker at the rear of the machine: 16 A

Switch on again by pressing in the black button at the rear of the machine.

### Material

- Maximum feed size in the case of hard material approx. 10 mm
- Maximum feed quantity 900 ml divided in 4 x 500 ml grinding bowls + grinding balls
- Achievable mean final fineness (depending on material) down to  $d_{50} < 1 \mu\text{m}$

### Final Fineness

- Dry grinding down to  $d_{50} < 20 \mu\text{m}$  (depending on material)
- Wet grinding down to  $d_{50} < 1 \mu\text{m}$  (depending on material)

## 2 Operating Safety

### 2.1 General Safety Instructions

- Read the operating instructions carefully before use.
- The instrument can only to be used for the purpose described in Section 1.3 Short Description of the Machine.
- Use only original accessories and original spare parts. Failure to do so may call into question the performance of the instrument.
- Do not use damaged accessories.
- The operators must be familiar with the contents of the operating instructions.  
To this end, for example, the operating instructions must with the instrument.
- Do not remove labels.
- Protective devices must not be made unserviceable or removed.
- Unauthorized modification of the instrument or any part thereof will result in the loss of the conformity to European directives which is asserted by Fritsch and the warranty.
- Wear protective gloves!  
Grinding bowls may be very hot after grinding.
- Wear safety glasses  
Wet grinding may cause high pressure in the grinding bowl-  
Danger of squirting!
- Wear ear protectors - noise level up to 85dB(A).
- Don't run the instrument several hours without cooling phases - Danger of overheating.
- Behaviour at all times must be such as to strictly preclude any accidents.
- Furthermore, the MAC values at place of work specified in the pertinent safety regulations must be adhered to. Where applicable, ventilation must be provided or the instrument must be operated under an exhaust hood.
- When oxidizable materials such as metals, organic materials, wood, coal, plastic, etc. are ground or sieved, the risk of spontaneous ignition (dust explosion) exists whenever the fine particles exceed a specific percentage. While such materials are being ground, it is therefore necessary to take special safety precautions (e.g. wet grinding) and the work must be supervised by a specialist.
- The instrument is not explosion-proof and is unsuitable to grind or sieve materials which are explosive, combustible or promote combustion.
- Do not allow the instrument to run unsupervised. Due to the vibrations, under certain operating conditions, the machine may creep along the surface on which it is located or mounted.



*observe operating instructions!!*



*wear protective gloves*



*wear safety goggles!*



*wear ear protectors!*



*Attention! risk of explosion*



## 2.2 Operators

- No one other than authorized persons should operate the instrument and it must be serviced and repaired by trained specialists.
- No one suffering from medical problems or under the influence of medications, drugs, alcohol or overtiredness should be permitted to operate the instrument.

## 2.3 Protective Devices

**Protective devices should be used for the intended purpose and must not be made unserviceable or removed.**

**All protective devices should be regularly checked for completeness and to ensure that they are functioning correctly. See section 6 Maintenance.**

The hood must be closed when the machine is started up.

The hood is locked:

- when the machine is disconnected from the mains supply
- during operation

**The hood can be opened only when the drive of the mill has come to a standstill.**

### Opening the hood when the machine is disconnected from the mains supply

- Insert the attached triangular wrench (A) through the bore, and turn clockwise.
- The closure hatch can now be opened after the spring-loaded lock at the front of the hood is opened.
- The instrument can now not be switched on. If it is to be switched on, the safety lock must be activated by turning the triangular wrench anticlockwise, and the hood must be closed.

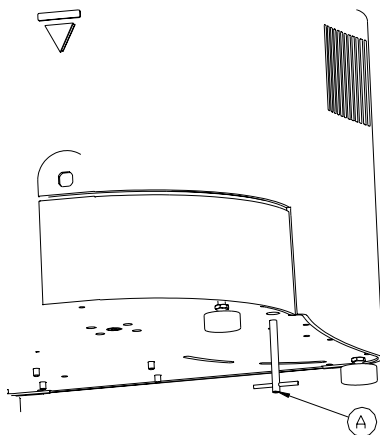

## 2.4 Danger Points

- Danger of crushing when the hood is being closed.
- Danger of crushing at the grinding bowl holder.

## 2.5 Electrical Safety

### 2.5.1 General

- The main switch disconnects the machine from the mains supply at two poles.
- Switch off the main switch if the instrument is to be inoperative for an extended period (e.g. over night).

### 2.5.2 Protection against Restarting

In the event of a mains failure during operation or after switching-off with the main switch, the hood will remain locked. When the mains voltage is restored, the lock of the hood will open. For safety reasons, however, the instrument will not start again.

### 2.5.3 Overload Protection

#### (see 8 Troubleshooting Checklist)

In the event of overloading, the speed of the machine will be reduced. This is indicated by the REDUCED SPEED light being illuminated.

If the drive motor overheats, the machine will switch off.

If the drive is obstructed, the machine will switch off.

### 2.5.4 Unbalance Detection

#### (see 8 Troubleshooting Checklist)

In the event of an excessive unbalance, the machine will switch off.

### 2.5.5 Operation on a residual current circuit breaker

It is possible that the leakage current could approach limit values during operation. This can result in tripping of residual current circuit breakers. Through the addition of all devices onto the power circuit, these values can be reached very quickly.

Solution: Use a power circuit without residual current circuit breaker or increase the residual current limit of the circuit breaker.



*Attention!*

## 3 Installation

### 3.1 Unpacking

- Pull out the nails with which the hood is fastened on the transport pallet. The hood is either a wooden box or a cardboard box placed over the transport pallet.
- Lift the hood off the transport pallet.
- Check that the items supplied correspond to your order. Grinding bowls of hardened steel may exhibit surface indentations caused by the manufacturing process. These do not influence the grinding or the grinding result and generally disappear after the first grinding. When present, these surface indentations lie within the permissible manufacturing tolerance ranges. Accordingly, complaints regarding such grinding bowls cannot be accepted.

### 3.2 Transport

Transport the mill on the transport pallet with a fork lift truck or a hand fork lift truck.

To carry the machine, grip it below the edge of the housing.

**Attention: Weight 120kg!**



*Do not step below lifted loads!*

### 3.3 Erection

- Lift the instrument with the transport pallet.

**Do not walk below the transport pallet.**

- The instrument is attached to the transport pallet with 7 screws. Undo the screws.
- Lift the instrument off the transport pallet.

**Attention: Weight 120kg!**

- Place the instrument on a level, stable surface, indoors. It is not necessary to fasten the instrument on the erection site. The instrument can also be mounted on a sturdy table.

**It is inadvisable to operate the instrument while it is standing on the transport pallet.**

- Ensure that there is good access to the instrument. There must be enough space to reach the main switch.
- Do not block the exit of air from the ventilator louver at the side. There is a danger of overheating if the louver is blocked.

### 3.4 Ambience conditions

- Use the instrument only inside.
- The air must not contain any electrical conductive dust.
- The ambient temperature must be between 5 and 40°C.
- Height up to 2000m M.S.L.
- Maximum relative humidity of air 80% temperature up to 31°C, linear decreasing down to 50% relative humidity of air at 40°C
- Contamination level 2 (IEC 664)

### 3.5 Electrical Connection

Before making the connection, compare the voltage and current values shown on the nameplate with the values of the mains supply to which the instrument is to be connected.

Single-phase alternating voltage with protective conductor (see section 1.4 Technical Data).



Attention! mains voltage

**The connecting cable may be changed only by a trained expert.**

### 3.6 Adaptation to Mains Supply Voltage, Changing Timer and Unbalance Detection in setup mode

**The voltage range of the machine should be switched over only by specialist staff.**

#### Adaptation to Mains Supply Voltage in setup mode

1. Disconnect the machine from the mains supply.
2. At the rear of the machine, set the changeover switch to the voltage range.
3. Connect the machine to the mains supply.
4. Press and hold down the STOP button on the control panel at the front.
5. Switch on the main switch at the rear of the machine and release the STOP button immediately afterwards.
6. The POWER SUPPLY light is flashing → **setup mode**  
The POWER SUPPLY light is not flashing, repeat the procedure
7. With the  /  ROTATIONAL SPEED buttons, select the mains supply voltage level (**90 - 260 V**).
8. To store the settings and end the **setup mode**, press the STOP button.

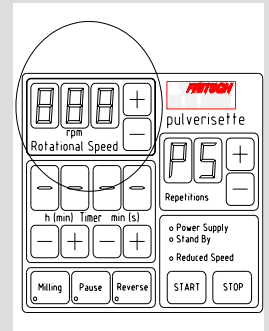

### Further options in setup mode

- A unbalance detection: on / off  
 (right)  button in the TIMER panel  
 unbalance detection on display: -  
 unbalance detection off display: 1
- B timer function: hours, minutes / minutes, seconds  
 (right)  button in the TIMER panel  
 Hours and minutes display: -  
 Minutes and seconds display: 1

**Switching off the unbalance detection at own risk!  
 see section 2 Operating Safety and 2.5 Electrical Safety**

**Pressing the REPETITIONS buttons in setup mode alters the machine type. Do not change anything here: P5 should be indicated in the display. Otherwise, damage will occur during operation.**

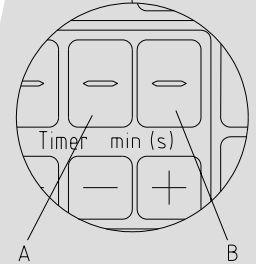
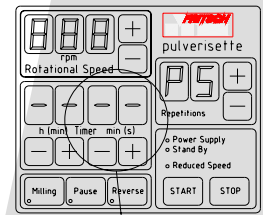

## 3.7 Switching On for the First Time / Test for Correct Functioning

Switch on the machine only when all the work described in section 3 Installation has been done.

### Switching On

1. Connect the machine to the mains supply.
2. Switch on the machine with the main switch at the rear.
3. POWER SUPPLY shines
4. Open the hood.
5. If the grinding bowl holder or any wood are present, take them out. There should be nothing in the grinding bowl holder.
6. Close the hood.
7. Press START on the control panel.
8. The hood will be locked and the mill will run at the preselected speed.

### Switching Off

- Press STOP on the control panel.
- After a short period (after the mill has come to a standstill), the hood is unlocked and can be opened.

## 4 Working with the mill

### 4.1 Choice of Grinding Bowls and Grinding Balls

#### Caution!!!

No warranty or claims shall be accepted in case of damages caused on account of using grinding bowls and grinding balls that are not original accessories of the appliance.

In order to prevent excessive abrasion, the hardness of the grinding bowl used and of the grinding balls must be higher than that of the material used.

| Material<br>(bowl and balls) |   | density*<br>in g/cm <sup>3</sup> | restistance to<br>abrasion |
|------------------------------|---|----------------------------------|----------------------------|
| Agate                        | (99.9% SiO <sub>2</sub> )   | 2.65                             | Good                       |
| Sintered corundum            | (99.7% Al <sub>2</sub> O <sub>3</sub> )                               | 3.8                              | Fairly good                |
| Zirconium dioxide            | (95% ZrO <sub>2</sub> )   | 5.7                              | Very good                  |
| Stainless steel              | Bowls:<br>(17-19% Cr + 8-10% Ni)<br>Balls:<br>(12,5-14,5% Cr + 1% Ni) | 7.8                              | Fairly good                |
| Tempered steel               | Bowls: (11-12% Cr)<br>Balls: (1,0-1,65% Cr)                           | 7.9                              | Good                       |
| Tungsten carbide             | (93%WC+6% Co)   | 14.7                             | Very good                  |
| Silicon nitride (Syalon)     | (90% Si <sub>3</sub> N <sub>4</sub> )                                 | 3.1                              | Extremely good             |

The grinding bowls and grinding balls of zirconium dioxide are resistant to acids with the exception of hydrofluoric acid.

Normally, grinding bowls and grinding balls of the same material should be chosen.

Exeption: Tungsten carbide balls may be combined with steel bowls.

The size of the grinding bowls and grinding balls should be determined experimentally.

#### 4.1.1 Size of the Grinding Balls

| Type of feed material                   | Ball diameter  |
|---|----------------|
| Hard samples feed particle size <10 mm  | 30 mm or 40 mm |
| Medium piece size (<5 mm)               | 20 mm          |
| Fine material (0.5 mm)                  | 10 mm or 5 mm  |
| Homogenisation of dry or liquid samples | 10 mm          |
| Homogenisation of viscous samples       | 20 mm          |

These are just clues: the size of the grinding bowls and grinding balls should be determined experimentally if necessary.

#### Attention:

We do not recommend to mix grinding balls with different diameters.

(If different ball diameters are used there is the danger of higher abrasion of the balls!)

\*High density means high impact energy

### 4.1.2 Number of Balls per Grinding Bowl

A larger number of balls reduces the grinding time, and the grinding result will lie within a narrower grain band width.

| Ball Ø (mm) | Grinding bowl volume (ml) | 80        | 250         | 500         |
|-------------|---------------------------|-----------|-------------|-------------|
| 5           | Number of balls (piece)   | 250 - 300 | 1200 - 1300 | 2000 - 2500 |
| 10          | Number of balls (piece)   | 30 - 35   | 50 - 150    | 100 - 250   |
| 15          | Number of balls (piece)   | 10        | 45 - 50     | 70 - 100    |
| 20          | Number of balls (piece)   | 5         | 15 - 20     | 25 - 35     |
| 30          | Number of balls (piece)   |           | 5 - 6       | 10          |
| 40          | Number of balls (piece)   |           |             | 4           |

These values are just clues: the number of balls should be determined experimentally if necessary.

**For Ø 30 and Ø 40 mm balls, please keep the machine under observation during operation. Because of the vibrations, there is a danger of the machine creeping.**

### 4.1.3 Calculated Ball Weight

| Ball diameter in mm        |                              | 5                           | 10   | 15    | 20    | 30     | 40     |
|----------------------------|------------------------------|-----------------------------|------|-------|-------|--------|--------|
| Material                   | density in g/cm <sup>3</sup> | Calculated ball weight in g |      |       |       |        |        |
| Agate                      | 2.65                         | 0.17                        | 1.39 | 4.68  | 11.10 | 37.46  | 88.80  |
| Sintered corundum          | 3.8                          | 0.25                        | 1.99 | 6.72  | 15.92 | 53.72  | 127.34 |
| Zirconium oxide            | 5.7                          | 0.37                        | 2.98 | 10.07 | 23.88 | 80.58  | 191.01 |
| Stainless steel            | 7.8                          | 0.51                        | 4.08 | 13.78 | 32.67 | 110.27 | 261.38 |
| Tempered steel             | 7.9                          | 0.52                        | 4.14 | 13.96 | 33.09 | 111.68 | 264.73 |
| Hardmetal tungsten carbide | 14.7                         | 0.96                        | 7.70 | 25.98 | 61.58 | 207.82 | 492.60 |
| Silicon nitride (Syalon)   | 3.1                          | 0.20                        | 1.62 | 5.48  | 12.99 | 43.83  | 103.88 |

To calculate the weight of the required balls, the “calculated ball weight” is multiplied by the “number” of balls needed.

Example: A 250 ml agate bowl must be filled with 1221 agate balls of 5 mm diameter.

Calculation:  $0.17 \text{ g} * 1221 \text{ balls} = 207.57 \text{ g}$

207.57 g of grinding balls can be weighed out and placed in the grinding bowl; this saves the time required for counting out the balls.

## 4.2 Filling the Grinding Bowl

| Grinding bowl | min. filling <sup>†</sup> | max. filling |
|---------------|---------------------------|--------------|
| 500ml         | 80ml                      | 225ml        |
| 250ml         | 30ml                      | 125ml        |
| 80ml          | 1ml                       | 30ml         |

**Using less sample material than recommended will cause higher abrasion!**

**It is imperative that the following sequence be observed:**

1. Place the grinding balls in the empty bowl.
2. Fill the material to be ground on the balls.

**Never use the mill without sample material!  
Danger of badly damage of the grinding balls and bowl!**

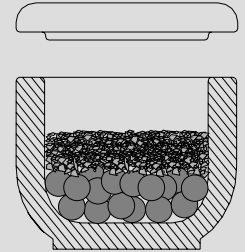

*filling the grinding bowl*

## 4.3 Influencing Quantities During Grinding

### Running time (grinding time)

A longer grinding time will increase the fine fraction.

### Speed

A higher speed will reduce the grinding time and increase the fine fraction.

### Reversing operation (regular reversal of the direction of rotation)

- useful for mechanical alloying
- improves homogenizing of the material

### Number and size of the balls

Pregrinding coarse, hard material with large balls:  
small fine fraction.

Use of many small balls will increase the fine fraction if the running time is increased.

### Mass of the balls (type of material)

A higher mass (density) of the grinding balls will accelerate the grinding.  
(see the table in section 4.1)

### 4.3.1 Dry Grinding

Below a particle size of approx. 20 µm, surface forces predominate and the material will start to "stick".

Further dry grinding can be achieved if surface-active substances are added to the material.

Examples (maximum quantity to be added in % by mass)

- Stearic acid 2-3%
- Aerosil (microdispersed silicic acid) 0.5-2%
- Silica sand ~ 2%
- Glass powder ~ 2%

<sup>†</sup> Filling = material to be ground



## 4.3.2 Wet Grinding (Grinding in Suspension)

When grinding in suspension, you can add auxiliary substances in liquid form with a high boiling point and low vapour pressure.

**Flammable liquids such as ketones and petroleum spirits with a boiling point <math>< 120^{\circ}\text{C}</math> should not be used.**



*Attention!  
flammable  
substances*

## 4.4 Clamping the grinding bowls

### 4.4.1 Clamping with the "Safe Lock" Holder

The following tests should be performed before the grinding bowls are clamped in the machine before each grinding operation:

- Is the black rubber disk inserted in the bowl holder (rough side up)? (Check before first run)
- Check the rubber disc in the bowl holder for damage. Replace rubber discs that are flattened.
- The flat Teflon seal (for sealing between the lid and the bowl) must not be damaged or dirty. Replace severely deformed flat Teflon seals.
- The surfaces of the lid and of the bowl on which the flat Teflon seal rests must be clean.
- Check the rubber disc at the safelock for damage. Replace rubber discs that are flattened and project laterally beyond the pressure piece.

### Clamping

Safe-lock 90.0900.00

fur Anl. 5/2000

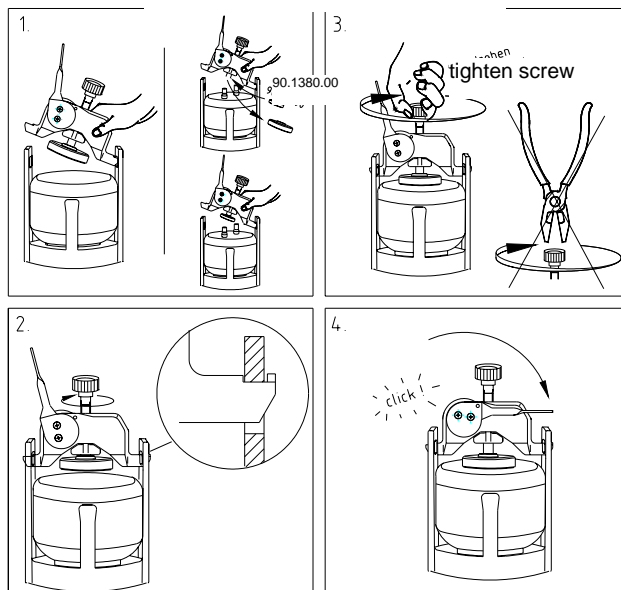

After a few minutes of grinding, and in the cooling phases, check that the clamping is secure.

### 4.4.2 Clamping the 80 ml grinding bowl

- Either use the 80 ml with the reducing piece fitted (order no. 90.1120.00) or
- use two 80 ml grinding bowls, one on top of the other.

### 4.4.3 Clamping with Additional Clamping System

Grinding bowls can be filled and then closed with the help of the Additional Clamping System in a box with protective gas, without being clamped in the mill.

It's also possible to clamp the gas lids with the Additional Clamping System. So they can be filled with protective gas out of the mill.

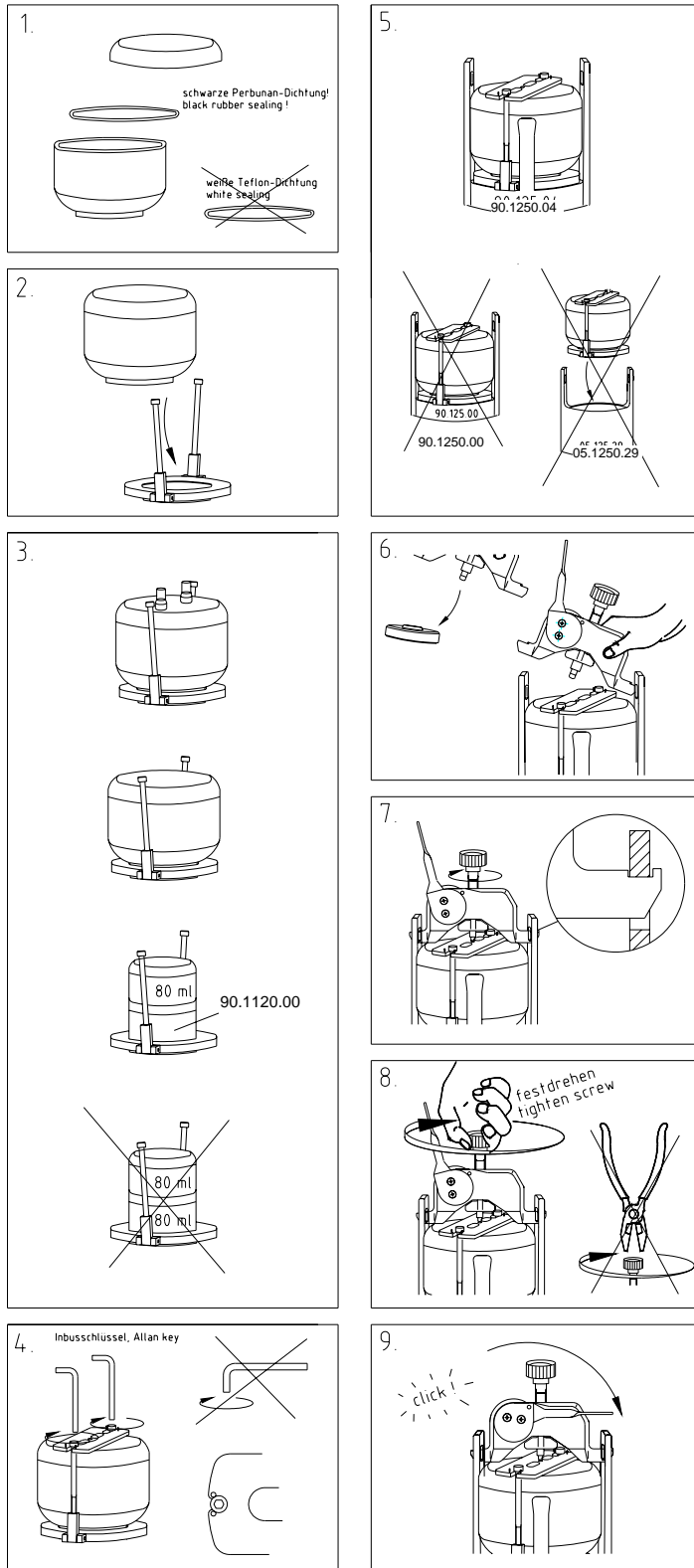

## 4.5 Mass Balance

### **Important! Symmetrical charging!**

For weight balancing, always clamp a grinding bowl of the same weight with a cover and sealing ring in the opposite pot mounting. As a temporary solution, use an empty bowl as a counterweight.

### **CAUTION**

**Additional weights like „GTM“ and additional clamping systems must also be balanced.**

## 4.6 Grinding Time

In accordance with the application, the grinding time should be adapted to the heating of the bowl.

**There is a max. temperature of 150°C allowed for the grinding bowls. The grinding time is determined by this temperature. The grinding time which does not exceed this temperature depends on the sample material, the balls and the speeds. For this reason the grinding time has to be determined experimentally by the user.**

### **clue**

In the case of grinding at high speeds and with large bowls, the grinding time should not exceed 1 hour. Then allow to cool for 0.5 to 1 hour.

**Pay attention to the heating of the material; in the case of extended running times, if necessary set a break time for cooling.**

To reduce the grinding time, choose grinding balls of a higher density.

**Before switching on again after a cooling phase, check that the clamping is secure.**

In the case of operation for mixing and homogenisation at low speeds, the mill may run for several hours without harm being done.

The machine cannot be operated with an external timer



*Attention! hot surface of grinding bowl*

## 4.7 Control Panel

- Switch on the main switch at the rear of the machine.
- The POWER SUPPLY light on the control panel will come on.

### 4.7.1 Setting the Speed

→ ROTATIONAL SPEED control panel area

Press or press and hold down the **+** or **-** button.

The speed can be selected in steps of 10 rpm between 50 rpm and 400 rpm.

During operation, the actual speed is indicated;

pressing the **+** or **-** button will cause the specified speed to be shown temporarily.

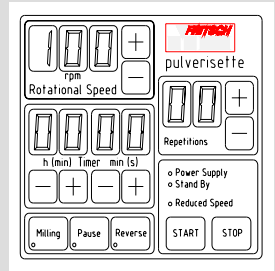

### 4.7.2 Setting the Running Time

→ TIMER control panel area

- Press the MILLING button. The button will light up. Press the **+** or **-** button and select the running time in hours (0..99) and minutes (0..60).
- Set a break time if this is required for cooling. Press the "Pause" button. The button will light up. Press the **+** or **-** button and select the break time in hours (0..99) and minutes (0..60). If no break time is required, set the break time to 0.

#### Notes:

- If the combination minutes/seconds instead of hours/minutes was set in the set-up mode (section 3.6), the **h** numbers indicate the minutes and the **min** numbers the seconds.
- During operation, the remaining running times and the remaining break times are indicated.
- The machine cannot be operated with an external timer.
- For information on running times, see section 4.6 Grinding Time
- To interrupt the grinding, press the STOP button; continue grinding by pressing the START button, n.b. account is taken of the grinding time already elapsed and of the number of repetitions.

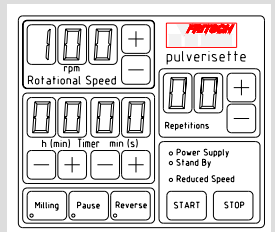

### 4.7.3 Reversing Operation

→ Press the REVERSE button.

The direction of rotation of the mill will now be changed after the chosen running time has elapsed. For this function REPETITIONS is set to minimal 1.

### 4.7.4 Repetition of the Grinding / Break Cycles

→ Repetitions control panel area

Press the **+** or **-** button and choose the number of repetitions (0..99).

During operation, the number of the remaining cycles is indicated.

## 4.8 Performing a Grinding Operation

- After everything has been set up as described in section 4 Working with the mill, close the hood.
- Press the START button on the control panel.
- The hood will be locked and the mill will run.
- The mill will rotate at the speed set (set speed) – if the load is too great, e.g. if the grinding bowl is too large, the machine will be run at a lower speed (actual speed) so as to prevent overloading.

If the mill does not start, see section 8 Troubleshooting Checklist.

### Overloading

In the event of overloading of the mill, the speed will be reduced and the REDUCED SPEED light will shine.

If it is overloaded for a prolonged period, the mill will switch off; see section 8 Troubleshooting Checklist.

### Miscellaneous

During operation, the hood will remain locked even during the breaks, and the fan will run.

### Switching Off

- Press STOP on the control panel.
- When the drive has come to a standstill, the hood is unlocked and can be opened.
- Switch off the main switch at the rear of the machine if the machine is to be inoperative for an extended period.

## 4.9 Cooling the Grinding Bowls

- with the hood open or
- at the programmed break times with the hood closed (locked) and the ventilator running.

## 4.10 Standby

After one hour, if the mill is not being operated and the hood is open, the mill will switch to the energy-saving standby mode. The STAND BY light will come on.

The standby function will not be activated when the hood is closed.



*Attention! hot surface of grinding bowl*

## 4.11 Grinding under protective gas with gas lid

**Important. Load the mill symmetrically! see section 4.5 Mass Balance**

For grinding under protective gas, the same conditions apply for the selection of the grinding set and grinding balls.

Two valves are screwed onto the gas lid. Before switching on the laboratory planetary mill, you can introduce protective gas, e.g. nitrogen, through these.

A Viton flat seal is used instead of the Teflon flat seal.

### Preparation for gassing

- Fill the grinding bowl with grinding balls and the material to be ground.
- Put on the lid with seal (use Viton seal).
- Insert the grinding bowl in the grinding bowl holder.
- Clamp the grinding bowl.

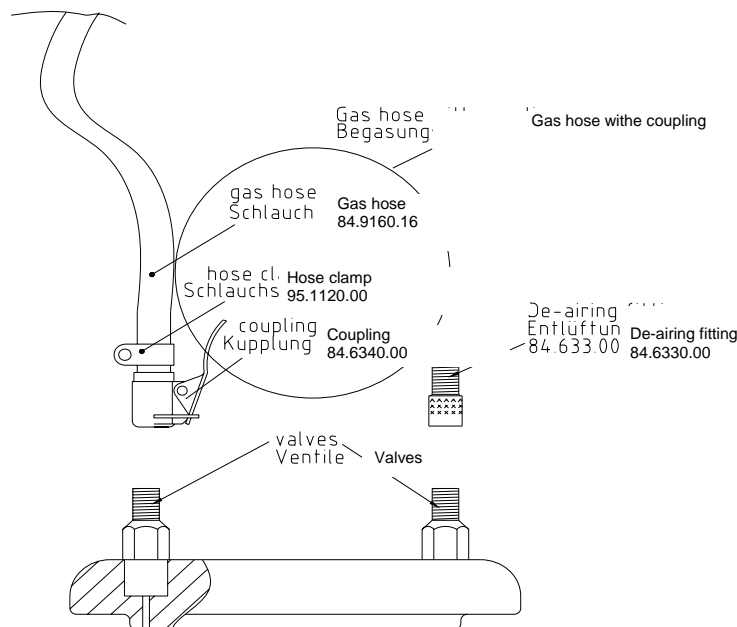

- Connect the gas hose to an insert gas supply with the aid of the attached hose clip.
- Screw the de-airing fitting onto one of the two valves.
- Fit the coupling of the gas hose onto the free valve. To do so, press the lever of the coupling and push the coupling onto the valve shaft as far as it will go. Release the lever.

### Gassing

- Slowly open the inert gas feed.
- Press on the top of the de-airing fitting so that the air can escape from the grinding bowl.
- The inert gas will now flush the air out of the grinding bowl.
- The flushing period must be determined experimentally; the flushing period is dependent on, inter alia, the grinding bowl size, the filling and the gas feed.
- To end the flushing, close the inert gas feed and release the de-airing fitting.
- Unscrew the de-airing fitting.
- Pull off the coupling of the gas hose. For this, press the lever.

### Warning

Switch the machine on only when both the coupling and the de-airing fitting have been removed.  
Excess pressure can occur during grinding.

### De-airing after grinding

- After grinding, screw on the de-airing fitting.
- For pressure equalisation, carefully press on the de-airing fitting.
- Release the grinding bowl clamping only after de-airing.

### Note

Either valve can be used for airing and de-airing.

### Cleaning the valves

Both valves should be cleaned after each grinding operation.

- For this, unscrew the valve insert with the attached valve turner. Insert the thin end of the valve turner into the valve from above and turn anticlockwise.
- Unscrew the valve insert.
- Depending on the contamination, clean the valve insert with compressed air or place the valve insert in a small glass vessel filled with alcohol, clean it in the ultrasonic bath (laborette 17) and carefully dry it.
- After both valve inserts have been removed, the two valve receptacles can be cleaned from the upper side of the lid with compressed air.

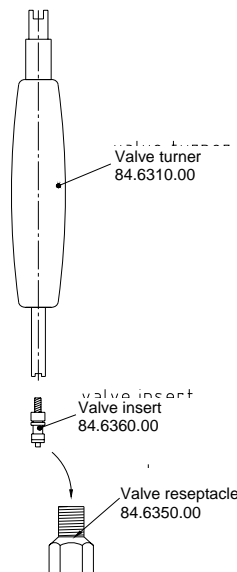

### Fitting the valve inserts

- Place the valve insert (spring pointing upwards) in the valve receptacle.
- Screw the valve insert in clockwise with the valve turner.

The following gas lids, each with two valves and a soft sealing ring, are available for the grinding sets:

| Material                     | Order number |
|------------------------------|--------------|
| Tungsten carbide 250 ml      | 50.8600.00   |
| Hardened chrome steel 80 ml  | 50.8700.00   |
| Hardened chrome steel 250 ml | 50.8500.00   |
| Hardened chrome steel 500 ml | 50.8400.00   |
| Stainless Cr-Ni steel 80 ml  | 50.8800.00   |
| Stainless Cr-Ni steel 250 ml | 50.8300.00   |
| Stainless Cr-Ni steel 500 ml | 50.8200.00   |
| Agate 250 ml                 | 50.8100.00   |
| Agate 500 ml                 | 50.8000.00   |

**The black, soft sealings made of Viton are temperature stabil up to 200°C.**  
**The valves are temperature stabil up to 180°C for one hour max.**

### 4.12 GTM System

The GTM system, order no. see price list, is available as an accessory for measuring the pressure and temperature in the grinding bowl during grinding.

Instructions are provided with the GTM system.



## 5 Cleaning

### 5.1 Grinding accessories

- Clean the grinding bowl and grinding balls after each use: e.g. brush them clean under running water with usual cleaning agents.
- Fill the grinding bowl with grinding balls and some sand and water half-full and run the planetary motormill for 2 to 3 minutes (with the grinding bowl correctly clamped in position).
- Cleaning in the ultrasonic bath is permissible.
- When sterilising the grinding bowl and grinding balls in the drying chamber, heat only to 250°C.

**Do not heat agate grinding parts above 110°C. Cool them slowly and carefully.**  
**Agate parts must never be heated in the microwave (they heat up too rapidly).**  
**They must never be subjected to temperature shocks, such shocks may destroy the parts → They burst apart explosively.**

### 5.2 Mill

- When switched off, the mill can be wiped down with a damp cloth.

**Do not allow any liquids to seep into the machine.**



## 6 Maintenance

**Before commencing maintenance work, disconnect the mains plug and secure the machine against being switched on again unintentionally.**  
**When maintenance work is being performed, this should be indicated with a warning sign.**

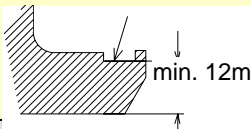

Attention! mains voltage

Regular cleaning is the most important part of maintenance.

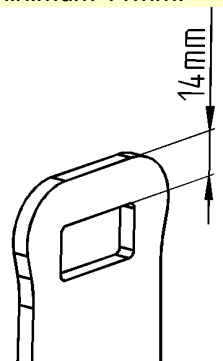
| Functional part                              | Task / Description  | Test  | Maintenance interval          |
|--|---|---|-------------------------------|
| Safety lock                                  | Locking the hood  | Is the closed hood held shut when the main switch is off?<br>If this test fails, you must not continue to work before the error is corrected                    | Before each use               |
| Rotating bearings                            | Permanent lubrication   | Bearing play  | Every 2,000 hours or annually |
| Drive motor                                  | Permanent lubrication   | Bearing play  | Every 4,000 hours or annually |
| V-belt                                       | Motor planet disc   | Check the tension<br>disconnect the mains plug, unscrew the upper plate at the back; the belt should not yield by more than approx. 10 mm under thumb pressure. | 1 x annually                  |
| Fan, Ventiduct                               | Cooling the grinding chamber and electronics                                  | Operation;<br>clean when dirty  | 2 x annually                  |
| Grinding bowl holder and clamping „safelock“ | rubber disk of the pressure piece and rubber disk in the grinding bowl holder | Signs of use;<br>when it has been pressed flat and is thus non-elastic, replace it  | Every 1,000 hours             |
|  | indicated area of safelock worn out height ex works 12.5mm                    | Safelock often was too softly tightened!!<br>                               | Every 200 hours               |
| seal grinding bowl                           | grinding bowl lid seal  | if dirt presse  ice it!  | Every 100 hours               |
| grinding bowl holder                         | support clamping system safelock  | minimum 11mm!<br>  | 1 x annually                  |

## 7 Warranty

The warranty card accompanying this instrument must be returned to the manufacturer, duly filled out, in order for the warranty to become effective.

The option of online registration is available. For further information, please refer to your warranty card or visit our Homepage

<http://www.fritsch.de>

We, Fritsch GmbH, Germany, our application technology laboratory and our agent in your country will gladly provide advice and assistance with this instrument.

Always include the serial number found on the nameplate with any queries.

## 8 Troubleshooting Checklist

| Malfunction                                  | Possible cause  | Elimination of error  |
|--|---|---|
| POWER SUPPLY display not illuminated         | Not connected to mains  | Plug in mains plug  |
|  | Main switch   | Switch on the main switch   |
|  | Automatic circuit breaker at the rear of the machine                                  | Switch on again by pressing in the black button at the rear of the machine. |
| START button pressed but mill does not start | if POWER SUPPLY display not illuminated check see above                               | see above   |
|  | Break time active   | wait for the break to end or press STOP                                     |
|  | safety lock was opened by hand  | see section 2.3 Protective Devices  |
| Mill speed reduced                           | if REDUCED SPEED shines: overloading  | Reduce the load or accept the reduced speed                                 |
| Mill stops                                   | overheating of the drive motor  | Let the mill coll down and select lower speed                               |
|  | Mass balance not adequate   | improve mass balance: see section 4.5 Mass Balance                          |
|  | drive is obstructed   | eliminate trouble in grinding chamber                                       |
|  | v-belt loosen or broken   | check or change v-belt  |
|  | speed sensor defective  | service to the customer   |
| hood cannot be opened                        | When the hood was being opened, the button at the front of the hood was not activated | Activate the button at the front of the hood and open the hood.             |
|  | Not connected to mains  | Plug in mains plug  |
|  | Main switch   | Switch on the main switch   |
|  | Automatic circuit breaker at the rear of the machine                                  | Switch on again by pressing in the black button at the rear of the machine. |
| Material escapes                             | Holder loose  | check   |
|  | Sealing ring defective or dirty   | Replace or clean the sealing ring   |
| Uneven running with severe vibration         | Mass balance not adequate   | improve mass balance: see section 4.5 Mass Balance                          |

## 9 Examples of Comminution Tasks

| Material | Material bowl and balls | balls<br>Qty x dia mm | Results        |
|----------|-------------------------|-----------------------|----------------|
| Quantity | Volume bowl             | Grinding time         | final fineness |

| <b>Ruby (Stone)</b>   |             |           |         |
|---|-------------|-----------|---------|
| 140 g   | Cr-Ni-steel | 6 x 30mm  | 100%    |
| 12 mm   | 250 ml      | 3 min     | <250µm  |
| <b>Titandioxid TiO<sub>2</sub> (Dry- and Wet grinding in water)</b> |             |           |         |
| 40 g  | Cr-Ni-steel | 6 x 30mm  | 100%    |
| 2 mm  | 250 ml      | 30 min    | < 40µm  |
| <b>Titandioxid TiO<sub>2</sub> (Wet grinding in water)</b>          |             |           |         |
| 40g/50ml watter   | Cr-Ni-steel | 6 x 30mm  | 100%    |
| 2 mm  | 250 ml      | 60 min    | < 10µm  |
| <b>Carbon (Dry- and Wet grinding in Water)</b>                      |             |           |         |
| 5 g   | Zirkonoxid  | 5 x 20mm  | 100%    |
| 0,5 mm  | 80 ml       | 120 min   | < 15µm  |
| <b>Aluminium oxide / Silizium oxide</b>                             |             |           |         |
| 100 g   | WC + Co     | 15 x 20mm | 90%     |
| 0,1 mm  | 250 ml      | 90 min    | < 20µm  |
| <b>Ferrovandium</b>   |             |           |         |
| 70 g  | WC + Co     | 5 x 30mm  | 70%     |
| 3 mm  | 250 ml      | 20 min    | <100µm  |
| <b>Glass</b>  |             |           |         |
| 50 g  | Achat       | 15 x 20mm | 100%    |
| 4 mm  | 250 ml      | 15 min    | < 90µm  |
| <b>Silicon carbide (Dry- and Wet grinding in Water)</b>             |             |           |         |
| 15 g  | WC + Co     | 5 x 20mm  | 100%    |
| 3 mm  | 80 ml       | 30 min    | <150µm  |
| <b>Silicon carbide (Dry- and Wet grinding in Water)</b>             |             |           |         |
| 15g/5 ml Wasser   | WC + Co     | 5 x 20mm  | 100%    |
| 3 mm  | 80 ml       | 45 min    | <71µm   |
| <b>Raw-phosphate</b>  |             |           |         |
| 40 g  | Cr-Stahl    | 15 x 20mm | 100%    |
| 3mm   | 250 ml      | 2 min     | <250 µm |

|             |                         |                       |                |
|-------------|-------------------------|-----------------------|----------------|
| Material    |                         |                       |                |
| Quantity    | Material bowl and balls | balls<br>Qty x dia mm | Results        |
| Edge length | Volume bowl             | Grinding time         | final fineness |

|  |                                |           |         |
|--|--------------------------------|-----------|---------|
| <b>Manganoous oxide</b> MnO <sub>2</sub> (Wet grinding in Water) |                                |           |         |
| 50g/40ml Wasser  | WC + Co                        | 15 x 20mm | 100%    |
| 0,1 mm   | 250 ml                         | 60 min    | <20µm   |
| <b>Sewage sludge (dry)</b>                                       |                                |           |         |
| 180 g  | Al <sub>2</sub> O <sub>3</sub> | 10 x 30mm | 100%    |
| 8 mm   | 500 ml                         | 30 min    | <250µm  |
| <b>Activated charcoal</b> (Wet grinding in Water)                |                                |           |         |
| 150 ml   | Cr-Ni-Stahl                    | 15 x 20mm | 100%    |
| 0,025 mm   | 250 ml                         | 30 min    | < 5µm   |
| <b>Gypsum</b>  |                                |           |         |
| 300 g  | Cr-Stahl                       | 10 x 30mm | 100%    |
| 10 mm  | 500 ml                         | 20 min    | <200µm  |
| <b>Protein</b>   |                                |           |         |
| 50 g   | Sinterkorund 1                 | 6 x 30mm  | 90%     |
| 20 mm  | 250 ml                         | 90 min    | < 50µm  |
| <b>Grain</b> (barley)  |                                |           |         |
| 100 g  | Sinterkorund 1                 | 3 x 40mm  | 100%    |
| 3 mm   | 500 ml                         | 20 min    | < 150µm |
| <b>Dough</b>   |                                |           |         |
| 100 g  | Sinterkorund 1                 | 10 x 30mm | 100%    |
| 5 mm   | 500 ml                         | 3 min     | < 250µm |
| <b>Sugar</b> (Wet grinding in alcohol)                           |                                |           |         |
| 200 g  | Achat                          | 10 x 30mm | 100%    |
| 1 mm   | 500 ml                         | 45 min    | < 10µm  |

## 10 List of Keywords

|                                  |        |                                     |        |
|----------------------------------|--------|-------------------------------------|--------|
| actual speed .....               | 14, 15 | Protection against Restarting ..... | 4      |
| Clamping the bowl .....          | 11     | Protective Devices .....            | 3      |
| Cleaning .....                   | 19     | protective gas .....                | 16     |
| Control Panel .....              | 14     | Repetitions .....                   | 14     |
| Cooling the Grinding Bowls ..... | 15     | Reversing Operation .....           | 14     |
| Danger Points .....              | 4      | Rotational Speed .....              | 14     |
| external timer .....             | 13     | Running Time .....                  | 14     |
| Grinding .....                   | 10, 15 | Setup-Mode .....                    | 14     |
| Grinding time .....              | 14     | specified speed .....               | 14, 15 |
| GTM-System .....                 | 18     | Speed .....                         | 14     |
| hood .....                       | 3, 15  | Standby .....                       | 15     |
| hood locked .....                | 15     | Suspension .....                    | 11     |
| Influencing Quantities During    |        | Switching On .....                  | 7      |
| Grinding .....                   | 10     | Technical Data .....                | 4      |
| Maintenance .....                | 20     | Temperature .....                   | 18     |
| Opening the hood .....           | 3      | Test for Correct Functioning .....  | 7      |
| Overheat Protection .....        | 4      | Troubleshooting Checklist .....     | 21     |
| Overload Protection .....        | 4      | Unbalance Detection .....           | 4      |
| Overloading .....                | 15     | voltage range .....                 | 6      |
| pressure .....                   | 18     | Wet Grinding .....                  | 11     |